

PENN TOWNSHIP SECTION 15 R 12 TWP 9 MORGAN COUNTY, OHIO

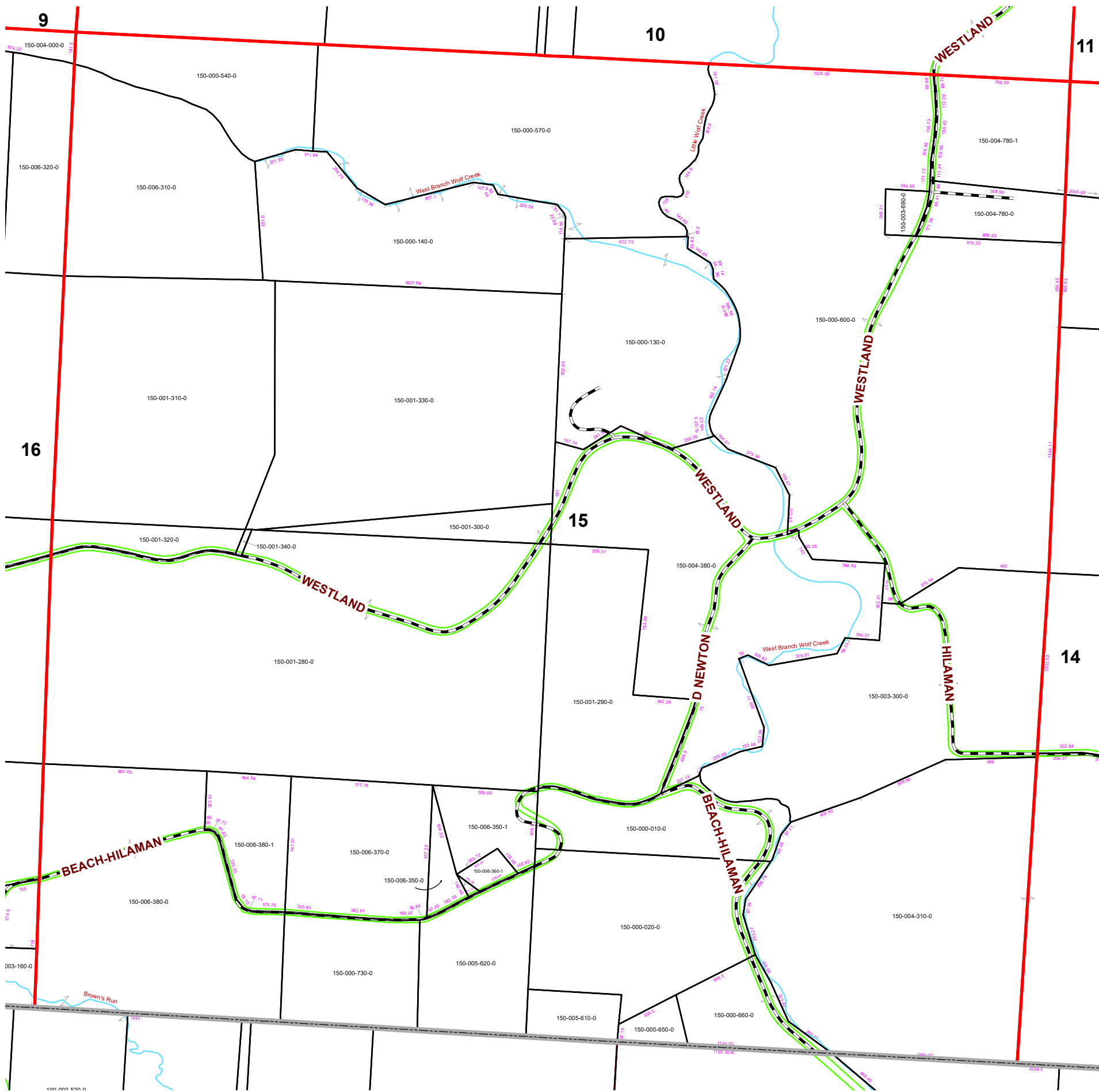

PIN	Owner	LegalDescr	Acres	VOL	PAGE	Survey_Ref
150-000-020-0	ABEL TIMOTHY A	R12 T09 S15 SD 11	20.63	OR193	440	NoSurvey.pdf
150-000-010-0	ABEL TIMOTHY A	R12 T09 S15 SD 17	8.46	OR193	440	NoSurvey.pdf
150-000-600-0	ACORN RIDGE LLC	R12 T09 S15 SD 43	98.035	OR211	173	PEN-0224.pdf
150-000-570-0	BLACKBURN DANIEL D & KATHI L	R12 T09 S15 SD 2-5 SU	42.5	OR120	757	NoSurvey.pdf
150-000-540-0	BLACKBURN DANIEL D & KATHI L	R12 T09 S15 SD 36 SUR	12.5	OR120	757	NoSurvey.pdf
150-004-780-0	CONNOR KIMBERLY L & JASEN R UPC	R12 T09 S15 SD 1	5.061	OR226	1432	PEN-0296.pdf
150-001-290-0	DOUGAN GLEN E TRUSTEE	R12 T09 S15 SD 10-32	18.79	OR202	1749	NoSurvey.pdf
150-001-280-0	DOUGAN GLEN E TRUSTEE	R12 T09 S15 SD 7	76.53	OR202	1749	NoSurvey.pdf
150-001-340-0	DOUGAN GLEN E TRUSTEE	R12 T09 S15 SD 38	0.12	OR202	1749	NoSurvey.pdf
150-001-320-0	DOUGAN GLEN E TRUSTEE	R12 T09 S15 SD 33	4.1	OR202	1749	NoSurvey.pdf
150-001-300-0	DOUGAN GLEN E TRUSTEE	R12 T09 S15 SD 34	4.22	OR202	1749	NoSurvey.pdf
150-001-330-0	DOUGAN GLEN E TRUSTEE	R12 T09 S15 SD 6	44.88	OR202	1749	NoSurvey.pdf
150-001-310-0	DOUGAN GLEN E TRUSTEE	R12 T09 S15 SD 37	35.55	OR202	1749	NoSurvey.pdf
150-006-350-0	ENGLER BRANDI E	R12 T09 S15 SD 28-29	1.708	OR228	3080	PEN-0290.pdf
150-006-380-1	ENGLER BRANDI E	R12 T09 S15 SD 46	6.606	OR228	3080	PEN-0290.pdf
150-006-370-0	ENGLER BRANDI E	R12 T09 S15 SD 9	13.374	OR228	3080	PEN-0290.pdf
150-003-690-0	KENNEDY DEAN A & MAYLE TRINA R	R12 T09 S15 SD 42 SUR	1.19	OR4	132	NoSurvey.pdf
150-003-300-0	LETHART PAUL W II TRUSTEE	R12 T09 S15 SD 41	34.12	OR192	490	NoSurvey.pdf
150-000-650-0	MCELROY IRREVOCABLE FAMILY TRU	R12 T09 S15 SD 39	1.56	OR231	1877	PEN-0177.pdf
150-000-660-0	MCELROY IRREVOCABLE FAMILY TRU	R12 T09 S15 SD 18	5.616	OR231	1877	PEN-0177.pdf
150-004-780-1	NEY ANDREW J & TERRY L	R12 T09 S15 SD 47 SUR	10.254	OR213	1860	PEN-0296.pdf
150-000-130-0	RAMBO KENT M & DIANE P	R12 T09 S15 SD 4 SUR	22.231	OR38	456	PEN-0140.pdf
150-000-140-0	RAMBO KENT M & DIANE P	R12 T09 S15 SD 14 SUR	21.744	OR38	456	PEN-0140.pdf
150-004-380-0	REES ALAN W & JUDITH K JARDINE	R12 T09 S15 SD 12 SUR	39.679	OR228	938	PEN-0267.pdf
150-004-310-0	SCHWARTZ ANDY L & KATIE J	R12 T09 S15 SD 13 SUR	48.994	OR230	973	PEN-0329.pdf
150-006-360-1	SHUSTER STEPHEN A	R12 T09 S15 SD 44	0.913	OR154	113	PEN-0054.pdf
150-006-350-1	SHUSTER STEPHEN A	R12 T09 S15 SD 45	5.015	OR154	113	PEN-0228.pdf
150-005-610-0	TOMLINSON GARY L & ANN E TRUSTE	R12 T09 S15 SD 19	3	OR203	3393	NoSurvey.pdf
150-005-620-0	TOMLINSON GARY L & ANN E TRUSTE	R12 T09 S15 SD 30	11	OR203	3393	NoSurvey.pdf
150-006-380-0	WILSON GAIL C TOD-RUSSELL A WILS	R12 T09 S15 SD 8	36.724	OR142	128	NoSurvey.pdf
150-006-310-0	WILSON GAIL C TOD-RUSSELL A WILS	R12 T09 S15 SD 15-21-	22	OR142	126	NoSurvey.pdf
150-000-730-0	WILSON HARLAN B & PAMELA G	R12 T09 S15 SD 16	10	OR58	494	NoSurvey.pdf

Source: Morgan County Engineer's Office
 Author: Marcia Wolfe
 Date: 12/31/20

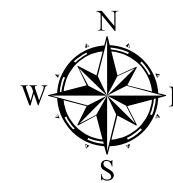
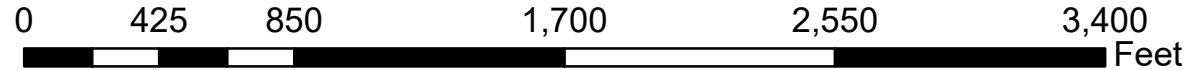

Boundaries			
	Hydro		Section
	Roads		Lot
	County		Township
	Parcel		ROW



Disclaimer: The information that these maps contains is for reference purposes only. Please bring any errors to the attention of the Engineer's Office staff. Thank you